

**TRAFFIC SWINGING SINGLE LEAF DOORS WITH TORSION HINGES**

ALL PRICES IN EURO, 2 MM THICK DOOR FRAME INCLUDED, VAT NOT INCLUDED

**(TSD TH)**

01.11.2021

- PH Insulation’s traffic swinging doors are designed to separate production and other premises in places with intensive traffic of personnel. The factory-made doors are ready for installation on technological, industrial premises, supermarkets, hospitals, food production facilities, cafes, restaurants, etc.
- PH Insulation’s doors with torsion hinges automatically return to the closed position and remain closed even in strong wind.
- All elements of torsion hinges are made of steel.
- Torsion hinges are less visible in the interior compared to standard hinges.

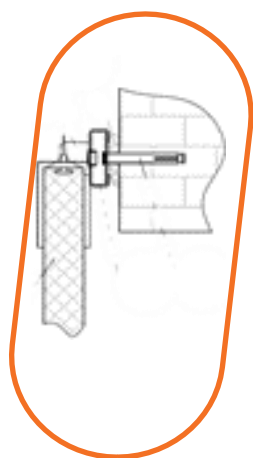

**OVERHEAD FRAME**

| INSTALLATION<br>OPENING, HEIGHT, MM | INSTALLATION OPENING, WIDTH, MM |     |     |      |      |      |      |
|-------------------------------------|---------------------------------|-----|-----|------|------|------|------|
|                                     | 700                             | 800 | 900 | 1000 | 1100 | 1200 | 1300 |
| 1800                                | 398                             | 405 | 412 | 423  | 431  | 446  | 506  |
| 1900                                | 405                             | 412 | 419 | 431  | 438  | 502  | 515  |
| 2000                                | 412                             | 419 | 427 | 438  | 446  | 510  | 523  |
| 2100                                | 419                             | 426 | 434 | 446  | 499  | 518  | 531  |
| 2200                                | 426                             | 433 | 441 | 453  | 507  | 526  | 539  |
| 2300                                | 437                             | 445 | 453 | 512  | 520  | 539  | 602  |
| 2400                                | 449                             | 457 | 465 | 524  | 533  | 553  | 617  |
| 2500                                | 510                             | 519 | 528 | 542  | 552  | 572  | 637  |
| 2600                                | 518                             | 527 | 537 | 551  | 561  | 631  | 647  |
| 2700                                | 526                             | 535 | 545 | 560  | 570  | 640  | 657  |
| 2800                                | 534                             | 543 | 553 | 568  | 626  | 649  | 666  |
| 2900                                | 587                             | 598 | 608 | 625  | 635  | 658  | 676  |
| 3000                                | 595                             | 605 | 616 | 633  | 644  | 668  | 685  |
| 3100                                | 603                             | 614 | 624 | 641  | 652  | 677  | 694  |
| 3200                                | 611                             | 622 | 632 | 650  | 661  | 686  | 704  |
| 3300                                | 619                             | 630 | 641 | 658  | 670  | 695  | 713  |

RAL 9003

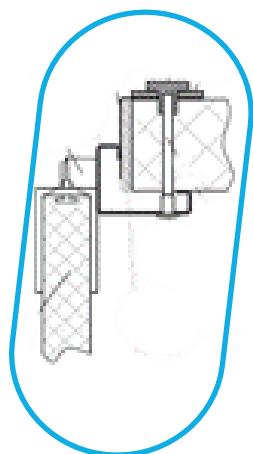

**ANGULAR FRAME**

| INSTALLATION<br>OPENING, HEIGHT, MM | INSTALLATION OPENING, WIDTH, MM |     |     |      |      |      |      |
|-------------------------------------|---------------------------------|-----|-----|------|------|------|------|
|                                     | 700                             | 800 | 900 | 1000 | 1100 | 1200 | 1300 |
| 1800                                | 420                             | 427 | 435 | 447  | 455  | 472  | 533  |
| 1900                                | 428                             | 435 | 443 | 456  | 464  | 528  | 542  |
| 2000                                | 436                             | 443 | 452 | 464  | 472  | 537  | 551  |
| 2100                                | 443                             | 452 | 460 | 473  | 527  | 546  | 561  |
| 2200                                | 451                             | 460 | 468 | 481  | 536  | 556  | 570  |
| 2300                                | 464                             | 472 | 481 | 541  | 550  | 570  | 634  |
| 2400                                | 476                             | 485 | 494 | 555  | 564  | 585  | 650  |
| 2500                                | 539                             | 549 | 559 | 574  | 584  | 606  | 673  |
| 2600                                | 549                             | 559 | 569 | 585  | 595  | 666  | 684  |
| 2700                                | 558                             | 568 | 578 | 594  | 605  | 677  | 694  |
| 2800                                | 566                             | 577 | 587 | 604  | 662  | 687  | 705  |
| 2900                                | 621                             | 632 | 643 | 661  | 672  | 697  | 715  |
| 3000                                | 630                             | 641 | 652 | 670  | 682  | 707  | 726  |
| 3100                                | 639                             | 650 | 661 | 680  | 692  | 717  | 736  |
| 3200                                | 647                             | 659 | 671 | 689  | 701  | 728  | 747  |
| 3300                                | 656                             | 668 | 680 | 699  | 711  | 738  | 757  |

RAL 9003

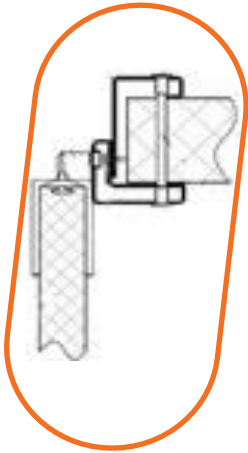

## OVERLAPPING FRAME

| RAL 9003 | INSTALLATION<br>OPENING, HEIGHT, MM | INSTALLATION OPENING, WIDTH, MM |     |     |      |      |      |
|----------|-------------------------------------|---------------------------------|-----|-----|------|------|------|
|          |                                     | 700                             | 800 | 900 | 1000 | 1100 | 1200 |
| 1800     | 494                                 | 504                             | 514 | 530 | 540  | 562  | 626  |
| 1900     | 505                                 | 515                             | 526 | 542 | 552  | 621  | 639  |
| 2000     | 516                                 | 527                             | 537 | 554 | 564  | 634  | 652  |
| 2100     | 528                                 | 538                             | 549 | 565 | 623  | 647  | 665  |
| 2200     | 539                                 | 550                             | 560 | 577 | 635  | 659  | 678  |
| 2300     | 556                                 | 567                             | 578 | 641 | 654  | 679  | 747  |
| 2400     | 572                                 | 584                             | 595 | 660 | 672  | 699  | 767  |
| 2500     | 641                                 | 653                             | 666 | 685 | 698  | 725  | 796  |
| 2600     | 653                                 | 666                             | 679 | 699 | 712  | 789  | 811  |
| 2700     | 666                                 | 679                             | 692 | 712 | 725  | 803  | 825  |
| 2800     | 678                                 | 691                             | 704 | 725 | 787  | 817  | 839  |
| 2900     | 736                                 | 750                             | 764 | 786 | 800  | 831  | 854  |
| 3000     | 748                                 | 762                             | 776 | 799 | 814  | 845  | 868  |
| 3100     | 760                                 | 775                             | 789 | 812 | 827  | 859  | 882  |
| 3200     | 772                                 | 787                             | 802 | 825 | 840  | 872  | 896  |
| 3300     | 785                                 | 799                             | 814 | 838 | 854  | 886  | 911  |

OUR DOORS ARE AVAILABLE IN CUSTOM SIZES TO INSURE BEST COMMERCIAL APPLICATION

## TRAFFIC SWINGING DOUBLE LEAF DOORS WITH TORSION HINGES

ALL PRICES IN EURO, 2 MM THICK DOOR FRAME INCLUDED, VAT NOT INCLUDED

(TDD TH)

01.11.2021

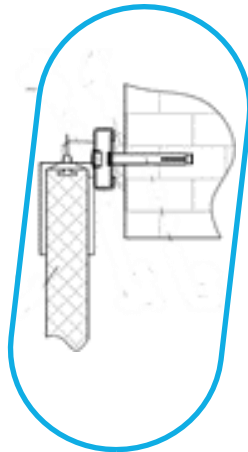

## OVERHEAD FRAME

| RAL 9003 | INSTALLATION<br>OPENING, HEIGHT, MM | INSTALLATION OPENING, WIDTH, MM |      |      |      |
|----------|-------------------------------------|---------------------------------|------|------|------|
|          |                                     | 1000                            | 1100 | 1200 | 1300 |
| 1800     | 596                                 | 599                             | 602  | 604  | 668  |
| 1900     | 605                                 | 608                             | 611  | 614  | 681  |
| 2000     | 614                                 | 618                             | 621  | 624  | 694  |
| 2100     | 624                                 | 627                             | 630  | 633  | 707  |
| 2200     | 633                                 | 636                             | 640  | 643  | 720  |
| 2300     | 649                                 | 653                             | 656  | 660  | 741  |
| 2400     | 665                                 | 669                             | 672  | 676  | 761  |
| 2500     | 766                                 | 770                             | 774  | 777  | 867  |
| 2600     | 779                                 | 782                             | 786  | 790  | 882  |
| 2700     |                                     |                                 |      | 801  | 897  |
| 2800     |                                     |                                 |      | 812  | 912  |
| 2900     |                                     |                                 |      | 916  | 1019 |
| 3000     |                                     |                                 |      | 927  | 1033 |
| 3100     |                                     |                                 |      | 938  | 1048 |
| 3200     |                                     |                                 |      | 949  | 1063 |
| 3300     |                                     |                                 |      | 961  | 1078 |

## OVERHEAD FRAME

|          | INSTALLATION<br>OPENING, HEIGHT, MM | INSTALLATION OPENING, WIDTH, MM |      |      |      |      |
|----------|-------------------------------------|---------------------------------|------|------|------|------|
|          |                                     | 1500                            | 1600 | 1700 | 1800 | 1900 |
| RAL 9003 | 1800                                | 670                             | 673  | 676  | 679  | 681  |
|          | 1900                                | 683                             | 686  | 689  | 692  | 695  |
|          | 2000                                | 697                             | 700  | 703  | 706  | 709  |
|          | 2100                                | 710                             | 713  | 716  | 719  | 722  |
|          | 2200                                | 723                             | 726  | 730  | 733  | 736  |
|          | 2300                                | 744                             | 747  | 751  | 754  | 849  |
|          | 2400                                | 765                             | 768  | 772  | 776  | 871  |
|          | 2500                                | 870                             | 874  | 877  | 881  | 885  |
|          | 2600                                | 886                             | 890  | 894  | 897  | 901  |
|          | 2700                                | 901                             | 905  | 909  | 913  | 917  |
|          | 2800                                | 916                             | 920  | 924  | 928  | 932  |
|          | 2900                                | 1023                            | 1027 | 1031 | 1035 | 1039 |
|          | 3000                                | 1038                            | 1042 | 1046 | 1050 | 1055 |
|          | 3100                                | 1053                            | 1057 | 1061 | 1066 | 1070 |
|          | 3200                                | 1067                            | 1072 | 1076 | 1081 | 1085 |
|          | 3300                                | 1082                            | 1087 | 1091 | 1096 | 1101 |

## OVERHEAD FRAME

|          | INSTALLATION<br>OPENING, HEIGHT, MM | INSTALLATION OPENING, WIDTH, MM |       |       |       |       |       |       |
|----------|-------------------------------------|---------------------------------|-------|-------|-------|-------|-------|-------|
|          |                                     | 2 000                           | 2 100 | 2 200 | 2 300 | 2 400 | 2 500 | 2 600 |
| RAL 9003 | 1800                                | 684                             | 687   | 690   | 693   | 696   | 788   | 791   |
|          | 1900                                | 698                             | 701   | 704   | 797   | 800   | 803   | 806   |
|          | 2000                                | 712                             | 715   | 718   | 811   | 814   | 817   | 820   |
|          | 2100                                | 726                             | 819   | 822   | 825   | 828   | 831   | 835   |
|          | 2200                                | 740                             | 833   | 836   | 839   | 842   | 846   | 849   |
|          | 2300                                | 852                             | 855   | 859   | 862   | 865   | 960   | 963   |
|          | 2400                                | 875                             | 878   | 882   | 885   | 889   | 984   | 987   |
|          | 2500                                | 889                             | 892   | 896   | 899   | 903   | 999   | 1002  |
|          | 2600                                | 905                             | 909   | 913   | 1008  | 1012  | 1016  | 1019  |
|          | 2700                                | 921                             | 925   | 928   | 1024  | 1028  | 1032  | 1036  |
|          | 2800                                | 936                             | 1032  | 1036  | 1040  | 1044  | 1048  | 1052  |
|          | 2900                                | 1043                            | 1048  | 1052  | 1056  | 1060  | 1064  | 1068  |
|          | 3000                                | 1059                            | 1063  | 1067  | 1072  | 1076  | 1080  | 1084  |
|          | 3100                                | 1074                            | 1079  | 1083  | 1087  | 1092  | 1096  | 1101  |
|          | 3200                                | 1090                            | 1094  | 1099  | 1103  | 1108  | 1112  | 1117  |
|          | 3300                                | 1105                            | 1110  | 1114  | 1119  | 1123  | 1128  | 1133  |

## ANGULAR FRAME

|          | INSTALLATION<br>OPENING, HEIGHT, MM | INSTALLATION OPENING, WIDTH, MM |      |      |      |      |
|----------|-------------------------------------|---------------------------------|------|------|------|------|
|          |                                     | 1000                            | 1100 | 1200 | 1300 | 1400 |
| RAL 9003 | 1800                                | 620                             | 623  | 626  | 629  | 693  |
|          | 1900                                | 630                             | 633  | 637  | 640  | 707  |
|          | 2000                                | 641                             | 644  | 647  | 651  | 721  |
|          | 2100                                | 651                             | 654  | 658  | 662  | 735  |
|          | 2200                                | 661                             | 665  | 669  | 672  | 750  |
|          | 2300                                | 679                             | 682  | 686  | 690  | 772  |
|          | 2400                                | 696                             | 700  | 704  | 708  | 794  |
|          | 2500                                | 798                             | 802  | 806  | 811  | 900  |
|          | 2600                                | 811                             | 816  | 820  | 824  | 917  |
|          | 2700                                |                                 |      |      | 836  | 933  |
|          | 2800                                |                                 |      |      | 849  | 949  |
|          | 2900                                |                                 |      |      | 953  | 1056 |
|          | 3000                                |                                 |      |      | 965  | 1072 |
|          | 3100                                |                                 |      |      | 977  | 1088 |
|          | 3200                                |                                 |      |      | 990  | 1104 |
|          | 3300                                |                                 |      |      | 1002 | 1120 |

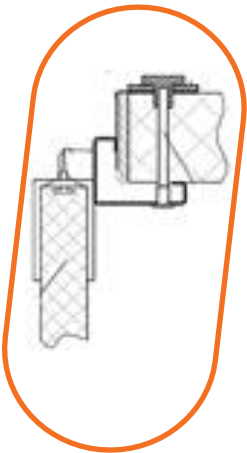

## ANGULAR FRAME

|          | INSTALLATION<br>OPENING, HEIGHT, MM | INSTALLATION OPENING, WIDTH, MM |      |      |      |      |
|----------|-------------------------------------|---------------------------------|------|------|------|------|
|          |                                     | 1500                            | 1600 | 1700 | 1800 | 1900 |
| RAL 9003 | 1800                                | 696                             | 699  | 703  | 706  | 709  |
|          | 1900                                | 710                             | 714  | 717  | 720  | 724  |
|          | 2000                                | 725                             | 728  | 732  | 735  | 739  |
|          | 2100                                | 739                             | 743  | 746  | 750  | 753  |
|          | 2200                                | 753                             | 757  | 761  | 764  | 768  |
|          | 2300                                | 775                             | 779  | 783  | 787  | 882  |
|          | 2400                                | 798                             | 802  | 806  | 810  | 905  |
|          | 2500                                | 904                             | 908  | 912  | 916  | 920  |
|          | 2600                                | 921                             | 925  | 930  | 934  | 938  |
|          | 2700                                | 937                             | 941  | 946  | 950  | 954  |
|          | 2800                                | 953                             | 957  | 962  | 966  | 971  |
|          | 2900                                | 1061                            | 1065 | 1070 | 1074 | 1079 |
|          | 3000                                | 1077                            | 1081 | 1086 | 1091 | 1095 |
|          | 3100                                | 1093                            | 1097 | 1102 | 1107 | 1112 |
|          | 3200                                | 1109                            | 1114 | 1118 | 1123 | 1128 |
|          | 3300                                | 1125                            | 1130 | 1135 | 1140 | 1145 |

## ANGULAR FRAME

|          | INSTALLATION<br>OPENING, HEIGHT, MM | INSTALLATION OPENING, WIDTH, MM |      |      |      |      |      |      |
|----------|-------------------------------------|---------------------------------|------|------|------|------|------|------|
|          |                                     | 2000                            | 2100 | 2200 | 2300 | 2400 | 2500 | 2600 |
| RAL 9003 | 1800                                | 712                             | 716  | 719  | 722  | 725  | 819  | 822  |
|          | 1900                                | 727                             | 731  | 734  | 827  | 831  | 834  | 837  |
|          | 2000                                | 742                             | 746  | 749  | 842  | 846  | 849  | 853  |
|          | 2100                                | 757                             | 850  | 854  | 858  | 861  | 865  | 868  |
|          | 2200                                | 772                             | 865  | 869  | 873  | 876  | 880  | 884  |
|          | 2300                                | 885                             | 889  | 893  | 897  | 901  | 995  | 999  |
|          | 2400                                | 909                             | 913  | 917  | 921  | 925  | 1021 | 1025 |
|          | 2500                                | 924                             | 929  | 933  | 937  | 941  | 1037 | 1041 |
|          | 2600                                | 942                             | 946  | 951  | 1046 | 1051 | 1055 | 1059 |
|          | 2700                                | 959                             | 963  | 967  | 1063 | 1068 | 1072 | 1076 |
|          | 2800                                | 975                             | 1071 | 1076 | 1080 | 1085 | 1089 | 1093 |
|          | 2900                                | 1083                            | 1088 | 1093 | 1097 | 1102 | 1106 | 1111 |
|          | 3000                                | 1100                            | 1105 | 1109 | 1114 | 1119 | 1123 | 1128 |
|          | 3100                                | 1116                            | 1121 | 1126 | 1131 | 1136 | 1140 | 1145 |
|          | 3200                                | 1133                            | 1138 | 1143 | 1148 | 1153 | 1158 | 1162 |
|          | 3300                                | 1150                            | 1155 | 1160 | 1165 | 1170 | 1175 | 1180 |

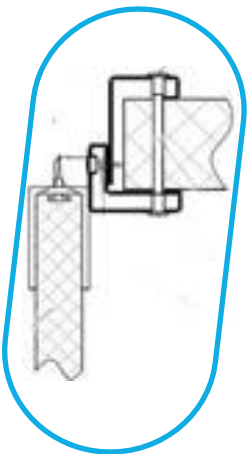

## OVERLAPPING FRAME

|          | INSTALLATION<br>OPENING, HEIGHT, MM | INSTALLATION OPENING, WIDTH, MM |      |      |      |      |
|----------|-------------------------------------|---------------------------------|------|------|------|------|
|          |                                     | 1000                            | 1100 | 1200 | 1300 | 1400 |
| RAL 9003 | 1800                                | 703                             | 708  | 713  | 718  | 784  |
|          | 1900                                | 717                             | 722  | 727  | 732  | 801  |
|          | 2000                                | 731                             | 736  | 741  | 746  | 819  |
|          | 2100                                | 745                             | 750  | 755  | 761  | 836  |
|          | 2200                                | 758                             | 764  | 769  | 775  | 854  |
|          | 2300                                | 780                             | 786  | 792  | 797  | 880  |
|          | 2400                                | 802                             | 808  | 814  | 819  | 907  |
|          | 2500                                | 908                             | 914  | 920  | 926  | 1017 |
|          | 2600                                | 925                             | 931  | 937  | 943  | 1037 |
|          | 2700                                |                                 |      |      | 958  | 1057 |
|          | 2800                                |                                 |      |      | 974  | 1076 |
|          | 2900                                |                                 |      |      | 1082 | 1187 |
|          | 3000                                |                                 |      |      | 1098 | 1207 |
|          | 3100                                |                                 |      |      | 1114 | 1226 |
|          | 3200                                |                                 |      |      | 1129 | 1245 |
|          | 3300                                |                                 |      |      | 1145 | 1265 |

## OVERLAPPING FRAME

|          | INSTALLATION<br>OPENING, HEIGHT, MM | INSTALLATION OPENING, WIDTH, MM |      |      |      |      |
|----------|-------------------------------------|---------------------------------|------|------|------|------|
|          |                                     | 1500                            | 1600 | 1700 | 1800 | 1900 |
| RAL 9003 | 1800                                | 788                             | 793  | 798  | 803  | 808  |
|          | 1900                                | 806                             | 811  | 816  | 821  | 826  |
|          | 2000                                | 824                             | 829  | 834  | 839  | 844  |
|          | 2100                                | 842                             | 847  | 852  | 857  | 863  |
|          | 2200                                | 859                             | 865  | 870  | 875  | 881  |
|          | 2300                                | 886                             | 892  | 897  | 903  | 999  |
|          | 2400                                | 913                             | 919  | 924  | 930  | 1028 |
|          | 2500                                | 1023                            | 1029 | 1034 | 1040 | 1046 |
|          | 2600                                | 1043                            | 1049 | 1055 | 1061 | 1067 |
|          | 2700                                | 1063                            | 1069 | 1075 | 1081 | 1087 |
|          | 2800                                | 1082                            | 1088 | 1095 | 1101 | 1107 |
|          | 2900                                | 1193                            | 1200 | 1206 | 1212 | 1219 |
|          | 3000                                | 1213                            | 1219 | 1226 | 1232 | 1239 |
|          | 3100                                | 1233                            | 1239 | 1245 | 1252 | 1258 |
|          | 3200                                | 1252                            | 1258 | 1265 | 1272 | 1278 |
|          | 3300                                | 1271                            | 1278 | 1285 | 1292 | 1298 |

## OVERLAPPING FRAME

|          | INSTALLATION<br>OPENING, HEIGHT, MM | INSTALLATION OPENING, WIDTH, MM |      |      |      |      |      |      |
|----------|-------------------------------------|---------------------------------|------|------|------|------|------|------|
|          |                                     | 2000                            | 2100 | 2200 | 2300 | 2400 | 2500 | 2600 |
| RAL 9003 | 1800                                | 813                             | 818  | 823  | 828  | 833  | 928  | 933  |
|          | 1900                                | 832                             | 837  | 842  | 937  | 942  | 947  | 952  |
|          | 2000                                | 850                             | 855  | 860  | 955  | 960  | 966  | 971  |
|          | 2100                                | 868                             | 963  | 969  | 974  | 979  | 985  | 990  |
|          | 2200                                | 886                             | 982  | 987  | 992  | 998  | 1003 | 1009 |
|          | 2300                                | 1005                            | 1010 | 1016 | 1021 | 1027 | 1123 | 1129 |
|          | 2400                                | 1033                            | 1039 | 1045 | 1051 | 1056 | 1154 | 1159 |
|          | 2500                                | 1052                            | 1058 | 1064 | 1069 | 1075 | 1173 | 1179 |
|          | 2600                                | 1073                            | 1079 | 1085 | 1183 | 1189 | 1195 | 1201 |
|          | 2700                                | 1093                            | 1099 | 1105 | 1203 | 1209 | 1215 | 1221 |
|          | 2800                                | 1113                            | 1211 | 1217 | 1223 | 1229 | 1236 | 1242 |
|          | 2900                                | 1225                            | 1231 | 1238 | 1244 | 1250 | 1257 | 1263 |
|          | 3000                                | 1245                            | 1252 | 1258 | 1264 | 1271 | 1277 | 1284 |
|          | 3100                                | 1265                            | 1272 | 1278 | 1285 | 1291 | 1298 | 1305 |
|          | 3200                                | 1285                            | 1292 | 1298 | 1305 | 1312 | 1319 | 1325 |
|          | 3300                                | 1305                            | 1312 | 1319 | 1325 | 1332 | 1339 | 1346 |

OUR DOORS ARE AVAILABLE IN CUSTOM SIZES TO INSURE BEST COMMERCIAL APPLICATION

## DOOR CATALOGUE CODES

TSD TH  
TDD TH  
RIGHT / LEFT

TRAFFIC SWINGING SINGLE LEAF DOORS WITH TORSION HINGES  
TRAFFIC SWINGING DOUBLE LEAF DOORS WITH TORSION HINGES  
HINGES ON THE RIGHT / HINGES ON THE LEFT

### EXAMPLE OF DOOR CATALOGUE CODE: TSD TH 800 2000 40 RAL9003/RAL9003 ANG RIGHT

| DOOR<br>TYPE | DOORWAY<br>WIDTH | DOORWAY<br>HEIGHT | DOOR<br>THICKNESS | DOOR LEAF METAL |          | FRAME<br>TYPE | HINGES<br>LOCATION |
|--------------|------------------|-------------------|-------------------|-----------------|----------|---------------|--------------------|
|              |                  |                   |                   | EXTERIOR        | INTERIOR |               |                    |
| TSD TH       | 800              | 2000              | 40                | RAL9003         | RAL9003  | ANGULAR       | RIGHT              |

## ADDITIONAL OPTIONS FOR TRAFFIC SWINGING DOORS

| ITEM   | PRICE |
|--|-------|
| TDD FRAME INSTALLATION HARDWARE TO INSULATED SANDWICH PANELS | 16    |
| TSD FRAME INSTALLATION HARDWARE TO INSULATED SANDWICH        | 12    |
| TDD FRAME INSTALLATION HARDWARE TO A BRICK WALL              | 10    |
| TSD FRAME INSTALLATION HARDWARE TO A BRICK WALL              | 5     |
| FRAME INSTALLATION HARDWARE FOR STEEL STUD CONSTRUCTION      | 3     |
| DOOR BLADE MATERIAL: AISI 304, PRICE FOR 1 SQ. M             | 42    |
| DOOR BLADE MATERIAL: AISI 430, PRICE FOR 1 SQ. M             | 31    |
| OVERHEAD FRAME AISI 304, PRICE FOR RUNNING METER             | 19    |
| ANGULAR FRAME AISI 304, PRICE FOR RUNNING METER              | 30    |
| OVERLAPPING FRAME AISI 304, PRICE FOR RUNNING METER          | 70    |
| OVERHEAD FRAME AISI 430, PRICE FOR RUNNING METER             | 13    |
| ANGULAR FRAME AISI 430, PRICE FOR RUNNING METER              | 20    |
| OVERLAPPING FRAME AISI 430, PRICE FOR RUNNING METER          | 48    |
| HIDDEN INSTALLATION HARDWARE FOR TSD                         | 58    |
| HIDDEN INSTALLATION HARDWARE FOR TDD                         | 69    |
| HIDDEN INSTALLATION HARDWARE FOR TSD WITH AISI 304 FRAME     | 80    |
| HIDDEN INSTALLATION HARDWARE FOR TDD WITH AISI 304 FRAME     | 94    |
| HIDDEN INSTALLATION HARDWARE FOR TSD WITH AISI 430 FRAME     | 71    |
| HIDDEN INSTALLATION HARDWARE FOR TDD WITH AISI 304 FRAME     | 84    |

## FACTORY INSTALLED BUMPERS FOR TSD TH

| BUMPER MATERIAL         | THICKNESS,<br>MM | PRICE FOR<br>SQ. M | PRICE FOR RUNNING METER |              |
|-------------------------|------------------|--------------------|-------------------------|--------------|
|                         |                  |                    | BOTTOM 0,25 M           | BOTTOM 0,5 M |
| AISI 304                | 1,5              | 151                | 38                      | 76           |
| AISI 430                | 1,5              | 116                | 29                      | 58           |
| ALUMINIUM CHECKER PLATE | 1,5              | 69                 | 17                      | 35           |
| FLAT HDPE PLASTIC       | 4,0              | 46                 | 12                      | 23           |
| CURVED HDPE PLASTIC     | 6,0              | 69                 | 17                      | 34           |

## FACTORY INSTALLED BUMPERS FOR TDD TH

| BUMPER MATERIAL         | THICKNESS,<br>MM | PRICE FOR<br>SQ. M | PRICE FOR RUNNING METER |              |
|-------------------------|------------------|--------------------|-------------------------|--------------|
|                         |                  |                    | BOTTOM 0,25 M           | BOTTOM 0,5 M |
| AISI 304                | 1,5              | 159                | 40                      | 79           |
| AISI 430                | 1,5              | 122                | 30                      | 61           |
| ALUMINIUM CHECKER PLATE | 1,5              | 73                 | 18                      | 36           |
| FLAT HDPE PLASTIC       | 4,0              | 47                 | 12                      | 24           |
| CURVED HDPE PLASTIC     | 4,0              | 53                 | 13                      | 27           |
| CURVED HDPE PLASTIC     | 6,0              | 70                 | 18                      | 35           |

## PACKAGING

| ITEM                | PRICE                                  |
|---------------------|--|
| STRETCH-WRAP        | INCLUDED IN DOOR PRICE                 |
| CARDBOARD PACKAGING | CALCULATED INDIVIDUALLY FOR YOUR ORDER |
| WOODEN PACKAGING    | CALCULATED INDIVIDUALLY FOR YOUR ORDER |

