

TRAFFIC SWINGING SINGLE LEAF DOORS WITH GRAVITY HINGES

ALL PRICES IN US DOLLARS, 2 MM THICK DOOR FRAME INCLUDED, VAT NOT INCLUDED

(TSD GR)

26.01.2021

- PH Insulation's traffic swinging doors are designed to separate premises with intensive traffic of personnel. The factory-made doors are ready for installation in supermarkets, restaurants, hospitals, food production facilities, etc.
- PH Insulation's doors with gravity hinges are set up faster with less adjustment compared to fixating hinges, need less maintenance and provide for increased dimensions of light opening.
- PH Insulation's traffic doors are not meant to completely seal the opening due to technical clearance gaps along the perimeter between the frame and the door leaf.

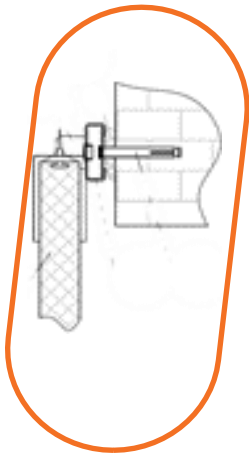

OVERHEAD FRAME

RAL 9003	INSTALLATION OPENING, HEIGHT, MM	INSTALLATION OPENING, WIDTH, MM						
		700	800	900	1000	1100	1200	1300
	1800	358	389	392	394	396	399	401
	1900	362	395	397	400	402	404	407
	2000	366	401	403	406	408	410	413
	2100	370	406	409	411	414	416	419
	2200	374	412	414	417	420	422	425
	2300	378	418	420	423	426	429	431
	2400	382	423	426	429	432	435	437
	2500	385	429	432	435	438	441	443
	2600	392	437	440	443	446	449	452
	2700	397	444	447	450	454	456	460
	2800	403	451	454	458	461	464	467
	2900	406	456	460	463	466	470	473
	3000	411	463	467	470	474	477	481
	3100	417	470	474	478	481	485	488
	3200	422	478	481	485	489	492	496
	3300	428	485	488	492	496	500	503

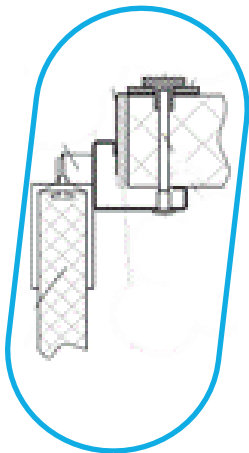

ANGULAR FRAME

RAL 9003	INSTALLATION OPENING, HEIGHT, MM	INSTALLATION OPENING, WIDTH, MM						
		700	800	900	1000	1100	1200	1300
	1800	378	410	413	415	418	420	423
	1900	382	416	419	422	425	427	430
	2000	387	423	426	428	431	434	437
	2100	392	429	432	435	438	440	443
	2200	396	435	438	441	444	447	450
	2300	401	442	445	448	451	454	457
	2400	405	448	451	454	457	461	464
	2500	410	454	458	461	464	467	470
	2600	417	463	467	470	473	477	480
	2700	423	471	475	478	482	485	488
	2800	429	479	483	486	489	493	497
	2900	435	487	490	494	498	501	505
	3000	441	494	498	502	506	510	513
	3100	447	502	506	510	514	518	522
	3200	453	510	514	518	522	526	530
	3300	459	518	522	526	530	534	538

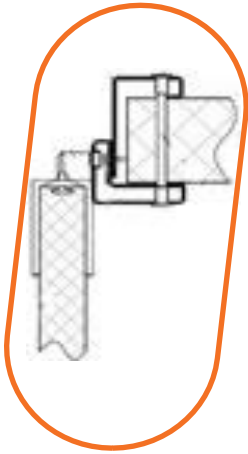
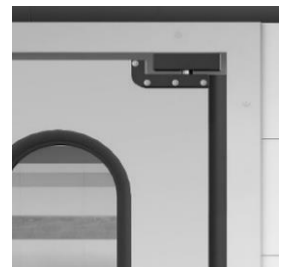

OVERLAPPING FRAME

INSTALLATION OPENING, HEIGHT, MM	INSTALLATION OPENING, WIDTH, MM						
	700	800	900	1000	1100	1200	1300
1800	432	466	470	473	477	481	484
1900	439	474	478	482	486	490	494
2000	446	483	487	491	495	499	503
2100	453	492	496	500	504	508	512
2200	460	500	505	509	513	517	521
2300	467	509	514	518	522	526	530
2400	474	518	522	527	531	535	540
2500	481	527	531	536	540	545	549
2600	490	538	543	547	552	556	561
2700	499	548	553	557	562	567	571
2800	507	558	563	568	573	577	582
2900	514	567	571	576	581	586	591
3000	522	577	582	587	592	597	602
3100	531	587	592	597	602	607	612
3200	539	597	602	607	613	618	623
3300	548	607	613	618	623	628	634

RAL 9003

OUR DOORS ARE AVAILABLE IN CUSTOM SIZES TO INSURE BEST COMMERCIAL APPLICATION

TRAFFIC SWINGING DOUBLE LEAF DOORS WITH GRAVITY HINGES

ALL PRICES IN US DOLLARS, 2 MM THICK DOOR FRAME INCLUDED, VAT NOT INCLUDED

(TDD GR)

26.01.2021

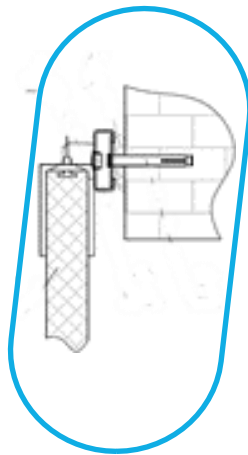

OVERHEAD FRAME

INSTALLATION OPENING, HEIGHT, MM	INSTALLATION OPENING, WIDTH, MM				
	1000	1100	1200	1300	1400
1800	623	625	627	630	691
1900	629	632	634	636	701
2000	636	638	641	643	711
2100	642	645	648	650	722
2200	649	652	654	657	732
2300	656	659	661	664	742
2400	662	665	668	671	752
2500	669	672	675	678	762
2600	680	684	687	690	778
2700				699	791
2800				709	804
2900				717	815
3000				727	829
3100				737	842
3200				736	855
3300				756	868

RAL 9003

OVERHEAD FRAME

	INSTALLATION OPENING, HEIGHT, MM	INSTALLATION OPENING, WIDTH, MM				
		1500	1600	1700	1800	1900
RAL 9003	1800	693	695	698	700	702
	1900	703	706	708	711	713
	2000	714	716	719	721	724
	2100	724	727	729	732	734
	2200	734	737	740	742	745
	2300	745	748	750	753	845
	2400	755	758	761	764	766
	2500	765	768	771	774	777
	2600	781	784	787	790	793
	2700	794	797	801	804	807
	2800	807	811	814	817	820
	2900	819	822	826	829	832
	3000	832	836	839	842	846
	3100	845	849	852	856	860
	3200	859	862	866	870	873
	3300	872	876	879	883	887

OVERHEAD FRAME

	INSTALLATION OPENING, HEIGHT, MM	INSTALLATION OPENING, WIDTH, MM						
		2 000	2 100	2 200	2 300	2 400	2 500	2 600
RAL 9003	1800	705	707	709	711	714	716	718
	1900	715	718	720	722	725	727	729
	2000	726	729	731	733	736	738	741
	2100	737	739	742	744	747	750	752
	2200	748	750	753	755	758	761	764
	2300	759	761	764	767	770	772	775
	2400	769	772	775	778	781	784	786
	2500	780	783	786	789	792	795	798
	2600	796	799	802	805	808	811	815
	2700	810	813	816	819	822	826	829
	2800	824	827	830	833	837	840	843
	2900	836	839	842	846	849	853	856
	3000	849	853	856	860	863	867	870
	3100	863	867	870	874	877	881	885
	3200	877	881	884	888	892	895	899
	3300	891	895	898	902	906	910	913

ANGULAR FRAME

	INSTALLATION OPENING, HEIGHT, MM	INSTALLATION OPENING, WIDTH, MM				
		1000	1100	1200	1300	1400
RAL 9003	1800	658	661	663	666	729
	1900	665	668	671	674	741
	2000	673	676	678	681	752
	2100	680	683	686	689	763
	2200	688	691	694	697	774
	2300	695	698	701	704	785
	2400	702	706	709	712	797
	2500	709	713	716	720	807
	2600	722	726	729	733	824
	2700				744	838
	2800				754	853
	2900				765	867
	3000				776	881
	3100				786	895
	3200				797	909
	3300				808	924

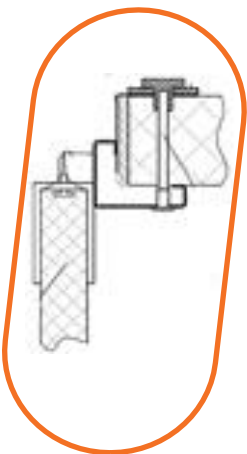

ANGULAR FRAME

	INSTALLATION OPENING, HEIGHT, MM	INSTALLATION OPENING, WIDTH, MM				
		1500	1600	1700	1800	1900
RAL 9003	1800	732	735	737	740	743
	1900	743	746	749	752	754
	2000	755	758	760	763	766
	2100	766	769	772	775	778
	2200	777	780	783	786	789
	2300	789	792	795	798	893
	2400	800	803	806	810	813
	2500	811	814	818	821	824
	2600	828	831	835	838	841
	2700	842	846	849	853	856
	2800	856	860	864	867	871
	2900	870	874	878	882	886
	3000	885	889	893	896	900
	3100	899	903	907	911	915
	3200	913	918	922	926	930
	3300	928	932	936	940	945

ANGULAR FRAME

	INSTALLATION OPENING, HEIGHT, MM	INSTALLATION OPENING, WIDTH, MM						
		2000	2100	2200	2300	2400	2500	2600
RAL 9003	1800	745	748	751	753	756	758	761
	1900	757	760	763	765	768	771	773
	2000	769	772	775	777	780	783	786
	2100	781	783	786	789	792	795	798
	2200	793	795	798	801	804	808	811
	2300	804	807	810	814	817	820	823
	2400	816	819	822	826	829	832	835
	2500	828	831	834	838	841	844	848
	2600	845	848	852	855	859	862	865
	2700	860	863	867	870	874	877	881
	2800	875	878	882	885	889	893	896
	2900	889	893	897	901	904	908	912
	3000	904	908	912	916	920	924	927
	3100	919	923	927	931	935	939	943
	3200	934	938	942	946	950	954	958
	3300	949	953	957	961	966	970	974

OVERLAPPING FRAME

	INSTALLATION OPENING, HEIGHT, MM	INSTALLATION OPENING, WIDTH, MM				
		1000	1100	1200	1300	1400
RAL 9003	1800	701	705	708	712	776
	1900	710	714	718	722	789
	2000	720	724	728	732	802
	2100	729	734	738	742	815
	2200	739	743	747	752	829
	2300	749	753	757	762	842
	2400	758	763	767	772	855
	2500	768	772	777	781	868
	2600	783	787	792	796	887
	2700				809	903
	2800				822	920
	2900				833	934
	3000				846	950
	3100				859	966
	3200				872	983
	3300				885	999

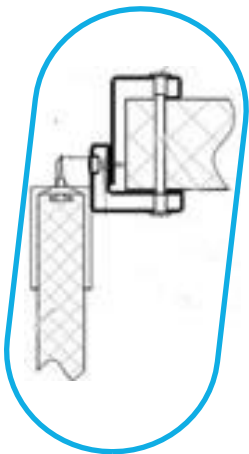

OVERLAPPING FRAME

	INSTALLATION OPENING, HEIGHT, MM	INSTALLATION OPENING, WIDTH, MM				
		1500	1600	1700	1800	1900
RAL 9003	1800	779	783	787	791	794
	1900	793	796	800	804	808
	2000	806	810	814	818	822
	2100	819	823	827	832	836
	2200	833	837	841	845	849
	2300	846	851	855	859	953
	2400	860	864	868	873	877
	2500	873	877	882	886	891
	2600	892	896	901	905	910
	2700	908	913	917	922	927
	2800	924	929	934	939	943
	2900	939	944	948	953	958
	3000	955	960	965	970	975
	3100	971	976	982	987	992
	3200	988	993	998	1003	1008
	3300	1004	1009	1015	1020	1025

OVERLAPPING FRAME

	INSTALLATION OPENING, HEIGHT, MM	INSTALLATION OPENING, WIDTH, MM						
		2000	2100	2200	2300	2400	2500	2600
RAL 9003	1800	798	802	806	809	813	817	821
	1900	812	816	820	823	827	831	835
	2000	826	830	834	838	841	846	850
	2100	840	844	848	852	856	860	864
	2200	854	858	862	866	870	874	878
	2300	868	872	876	880	885	893	897
	2400	881	886	890	894	899	903	907
	2500	895	900	904	909	913	917	922
	2600	914	919	924	928	932	937	942
	2700	931	936	941	945	950	955	959
	2800	948	953	958	962	967	972	977
	2900	963	968	973	978	983	988	992
	3000	980	985	990	995	1000	1005	1010
	3100	997	1002	1007	1012	1017	1022	1027
	3200	1014	1019	1024	1029	1034	1040	1045
	3300	1031	1036	1041	1046	1052	1057	1062

OUR DOORS ARE AVAILIABLE IN CUSTOM SIZES TO INSURE BEST COMMERCIAL APPLICATION

DOOR CATALOGUE CODES

TSD	SWINGING SINGLE LEAF DOORS
TDD	SWINGING DOUBLE LEAF DOORS
RIGHT / LEFT	HINGES ON THE RIGHT / HINGES ON THE LEFT

EXAMPLE OF DOOR CATALOGUE CODE: TSD 800 2000 40 RAL9003/RAL9003 ANG RIGHT

DOOR TYPE	DOORWAY WIDTH	DOORWAY HEIGHT	DOOR THICKNESS	COVERING MATERIAL		FRAME TYPE	HINGES LOCATION
				EXTERIOR METAL	INTERIOR METAL		
TSD	800	2000	40	RAL9003	RAL9003	ANGULAR	RIGHT

ADDITIONAL OPTIONS FOR TRAFFIC SWINGING DOORS

ITEM	PRICE
TDD FRAME INSTALLATION HARDWARE TO INSULATED SANDWICH PANELS	18
TSD FRAME INSTALLATION HARDWARE TO INSULATED SANDWICH	13
TDD FRAME INSTALLATION HARDWARE TO A BRICK WALL	11
TSD FRAME INSTALLATION HARDWARE TO A BRICK WALL	6
FRAME INSTALLATION HARDWARE FOR STEEL STUD CONSTRUCTION	3
DOOR BLADE MATERIAL: AISI 304, PRICE FOR 1 SQ. M	28
DOOR BLADE MATERIAL: AISI 430, PRICE FOR 1 SQ. M	18
OVERHEAD FRAME AISI 304, PRICE FOR RUNNING METER	14
ANGULAR FRAME AISI 304, PRICE FOR RUNNING METER	22
OVERLAPPING FRAME AISI 304, PRICE FOR RUNNING METER	52
OVERHEAD FRAME AISI 430, PRICE FOR RUNNING METER	8
ANGULAR FRAME AISI 430, PRICE FOR RUNNING METER	13
OVERLAPPING FRAME AISI 430, PRICE FOR RUNNING METER	30
HIDDEN INSTALLATION HARDWARE FOR TSD	54
HIDDEN INSTALLATION HARDWARE FOR TDD	63
HIDDEN INSTALLATION HARDWARE FOR TSD WITH AISI 304 FRAME	76
HIDDEN INSTALLATION HARDWARE FOR TDD WITH AISI 304 FRAME	90
HIDDEN INSTALLATION HARDWARE FOR TSD WITH AISI 430 FRAME	72
HIDDEN INSTALLATION HARDWARE FOR TDD WITH AISI 304 FRAME	84

FACTORY INSTALLED BUMPERS FOR TSD

BUMPER MATERIAL	THICKNESS, MM	PRICE FOR SQ. M	PRICE FOR RUNNING METER	
			BOTTOM 0,25 M	BOTTOM 0,5 M
AISI 304	1,5	62	16	31
AISI 430	1,5	45	11	22
ALUMINIUM CHECKER PLATE	1,5	45	11	23
FLAT HDP PLASTIC	4,0	25	6	13
CURVED HDP PLASTIC	6,0	36	9	18

FACTORY INSTALLED BUMPERS FOR TDD

BUMPER MATERIAL	THICKNESS, MM	PRICE FOR SQ. M	PRICE FOR RUNNING METER	
			BOTTOM 0,25 M	BOTTOM 0,5 M
AISI 304	1,5	64	16	32
AISI 430	1,5	46	12	23
ALUMINIUM CHECKER PLATE	1,5	46	11	23
FLAT HDP PLASTIC	4,0	34	9	17
CURVED HDP PLASTIC	4,0	34	9	17
CURVED HDP PLASTIC	6,0	38	10	19

PACKAGING

ITEM	PRICE
STRETCH-WRAP	INCLUDED IN DOOR PRICE
CARDBOARD PACKAGING	CALCULATED INDIVIDUALLY FOR YOUR ORDER
WOODEN PACKAGING	CALCULATED INDIVIDUALLY FOR YOUR ORDER

