

TRAFFIC SWINGING SINGLE LEAF DOORS WITH GRAVITY HINGES

ALL PRICES IN EURO, 2 MM THICK DOOR FRAME INCLUDED, VAT NOT INCLUDED

(TSD GR)

08.07.2024

- PH Insulation's traffic swinging doors are designed to separate premises with intensive traffic of personnel. The factory-made doors are ready for installation in supermarkets, restaurants, hospitals, food production facilities, etc. Doors can be equipped with oval windows of 200x500 or 300x580 mm.
- PH Insulation's doors with gravity hinges are set up faster with less adjustment compared to fixating hinges, need less maintenance and provide for increased dimensions of light opening.
- PH Insulation's traffic doors are not meant to completely seal the opening due to technical clearance gaps along the perimeter between the frame and the door leaf.

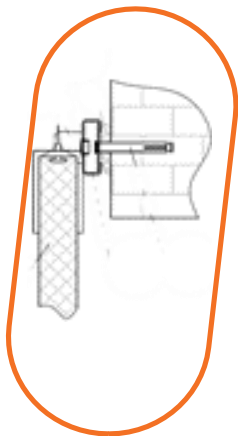

OVERHEAD FRAME

INSTALLATION OPENING, HEIGHT, MM	INSTALLATION OPENING, WIDTH, MM						
	700	800	900	1 000	1 100	1 200	1 300
1 800	327	359	366	377	383	398	409
1 900	331	365	372	382	390	404	416
2 000	335	370	377	388	396	411	422
2 100	339	376	383	394	402	417	429
2 200	343	382	389	401	408	424	436
2 300	347	387	395	407	414	431	443
2 400	352	394	402	414	422	438	451
2 500	356	399	407	419	428	445	458
2 600	363	409	417	430	438	456	469
2 700	368	415	423	437	445	463	477
2 800	373	422	430	444	452	471	484
2 900	379	430	439	452	461	480	494
3 000	384	436	445	459	469	488	502
3 100	389	443	453	467	476	496	511
3 200	394	450	459	474	484	503	518
3 300	400	457	467	482	492	512	528

RAL 9003

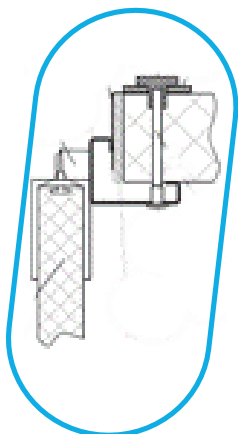

ANGULAR FRAME

INSTALLATION OPENING, HEIGHT, MM	INSTALLATION OPENING, WIDTH, MM						
	700	800	900	1 000	1 100	1 200	1 300
1 800	344	377	384	395	402	418	429
1 900	349	383	391	402	410	425	437
2 000	353	389	397	409	416	432	445
2 100	359	396	404	416	424	441	453
2 200	364	403	411	424	432	449	462
2 300	368	410	418	430	439	456	469
2 400	373	416	424	437	445	463	477
2 500	377	422	431	444	453	471	485
2 600	385	431	440	454	463	481	496
2 700	391	439	448	462	472	490	505
2 800	397	447	456	471	480	500	514
2 900	403	455	465	479	489	509	524
3 000	410	463	473	488	498	518	534
3 100	415	471	481	496	506	527	542
3 200	422	479	489	504	515	536	552
3 300	427	486	496	512	523	544	561

RAL 9003



OVERLAPPING FRAME

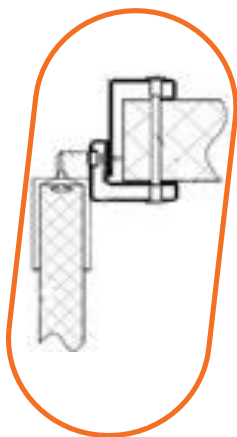

RAL 9003	INSTALLATION OPENING, HEIGHT, MM	INSTALLATION OPENING, WIDTH, MM					
		700	800	900	1 000	1 100	1 200
1 800	402	438	447	460	470	488	502
1 900	409	446	455	469	479	498	512
2 000	417	456	465	480	490	509	524
2 100	424	464	474	489	499	519	534
2 200	432	475	485	500	510	531	546
2 300	439	483	494	509	519	540	556
2 400	450	496	506	522	533	555	571
2 500	455	504	514	531	542	564	581
2 600	464	514	525	541	553	575	593
2 700	473	526	537	554	566	589	606
2 800	481	535	546	564	576	599	617
2 900	491	547	559	577	589	613	632
3 000	502	560	572	590	602	627	646
3 100	509	569	581	600	613	638	657
3 200	517	579	592	610	624	649	669
3 300	525	588	601	621	634	660	680

OUR DOORS ARE AVAILABLE IN CUSTOM SIZES TO INSURE BEST COMMERCIAL APPLICATION

TRAFFIC SWINGING DOUBLE LEAF DOORS WITH GRAVITY HINGES

ALL PRICES IN EURO, 2 MM THICK DOOR FRAME INCLUDED, VAT NOT INCLUDED

(TDD GR)

08.07.2024

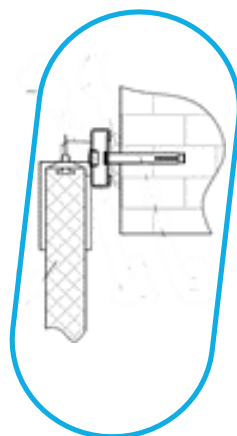

OVERHEAD FRAME

RAL 9003	INSTALLATION OPENING, HEIGHT, MM	INSTALLATION OPENING, WIDTH, MM			
		1 000	1 100	1 200	1 300
1 800	590	593	600	603	659
1 900	596	599	606	609	669
2 000	604	607	614	618	681
2 100	610	614	621	624	691
2 200	617	620	628	631	701
2 300	624	628	636	639	712
2 400	631	635	643	646	722
2 500	639	643	651	655	734
2 600	651	655	663	667	749
2 700				676	762
2 800				685	774
2 900				694	786
3 000				705	800
3 100				715	813
3 200				724	826
3 300				734	839

OVERHEAD FRAME

	INSTALLATION OPENING, HEIGHT, MM	INSTALLATION OPENING, WIDTH, MM				
		1 500	1 600	1 700	1 800	1 900
RAL 9003	1 800	662	665	668	671	674
	1 900	672	676	679	682	685
	2 000	684	687	690	694	697
	2 100	694	698	701	704	708
	2 200	704	708	711	715	719
	2 300	716	720	723	727	731
	2 400	726	730	734	738	741
	2 500	738	742	746	750	754
	2 600	754	758	762	766	770
	2 700	766	770	775	779	783
	2 800	778	783	787	792	796
	2 900	791	796	800	805	809
	3 000	805	810	814	819	824
	3 100	818	823	828	833	838
	3 200	831	836	841	846	851
	3 300	845	850	855	860	865

OVERHEAD FRAME

	INSTALLATION OPENING, HEIGHT, MM	INSTALLATION OPENING, WIDTH, MM						
		2 000	2 100	2 200	2 300	2 400	2 500	2 600
RAL 9003	1 800	677	680	683	686	689	692	695
	1 900	688	691	695	698	701	704	707
	2 000	700	704	707	710	714	717	720
	2 100	711	715	718	722	725	728	732
	2 200	722	726	729	733	736	740	744
	2 300	735	738	742	746	749	753	757
	2 400	745	749	753	757	761	765	769
	2 500	758	762	766	770	774	778	782
	2 600	774	778	783	787	791	795	799
	2 700	787	792	796	800	805	809	813
	2 800	801	805	809	814	818	823	827
	2 900	814	818	823	828	832	837	841
	3 000	828	833	838	843	847	852	857
	3 100	843	847	852	857	862	867	872
	3 200	856	861	866	871	876	881	886
	3 300	870	876	881	886	891	896	901

ANGULAR FRAME

	INSTALLATION OPENING, HEIGHT, MM	INSTALLATION OPENING, WIDTH, MM				
		1 000	1 100	1 200	1 300	1 400
RAL 9003	1 800	608	611	618	622	679
	1 900	616	620	627	630	691
	2 000	623	627	634	638	702
	2 100	632	636	643	647	714
	2 200	641	645	653	657	727
	2 300	648	652	660	664	738
	2 400	655	659	667	672	748
	2 500	664	668	677	681	761
	2 600	677	681	690	694	778
	2 700				705	793
	2 800				716	807
	2 900				726	820
	3 000				738	835
	3 100				747	848
	3 200				756	859
	3 300				765	872

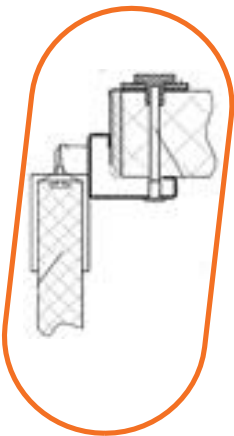

ANGULAR FRAME

	INSTALLATION OPENING, HEIGHT, MM	INSTALLATION OPENING, WIDTH, MM				
		1 500	1 600	1 700	1 800	1 900
RAL 9003	1 800	682	686	689	692	696
	1 900	694	698	701	705	708
	2 000	705	709	712	716	720
	2 100	718	722	726	729	733
	2 200	731	735	739	743	746
	2 300	742	746	750	754	758
	2 400	753	757	761	765	769
	2 500	766	770	774	779	783
	2 600	783	787	792	796	801
	2 700	797	802	807	811	816
	2 800	812	817	821	826	831
	2 900	825	830	835	840	845
	3 000	840	845	850	855	860
	3 100	853	858	863	869	874
	3 200	865	870	875	881	886
	3 300	878	883	889	894	900

ANGULAR FRAME

	INSTALLATION OPENING, HEIGHT, MM	INSTALLATION OPENING, WIDTH, MM						
		2 000	2 100	2 200	2 300	2 400	2 500	2 600
RAL 9003	1 800	699	702	705	709	712	715	719
	1 900	712	715	719	722	725	729	732
	2 000	723	727	730	734	738	741	745
	2 100	737	741	744	748	752	755	759
	2 200	750	754	758	762	766	770	774
	2 300	762	766	770	774	778	782	786
	2 400	774	778	782	786	790	794	799
	2 500	787	792	796	800	804	809	813
	2 600	805	810	814	818	823	827	832
	2 700	820	825	830	834	839	843	848
	2 800	836	840	845	850	855	860	864
	2 900	850	854	859	864	869	874	879
	3 000	865	870	875	880	886	891	896
	3 100	879	884	890	895	900	905	910
	3 200	891	897	902	907	913	918	923
	3 300	905	911	916	922	927	933	938

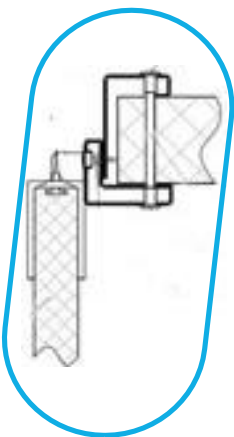

OVERLAPPING FRAME

	INSTALLATION OPENING, HEIGHT, MM	INSTALLATION OPENING, WIDTH, MM				
		1 000	1 100	1 200	1 300	1 400
RAL 9003	1 800	676	681	689	694	754
	1 900	686	691	699	704	767
	2 000	695	700	709	713	780
	2 100	708	713	722	726	797
	2 200	717	722	731	736	810
	2 300	727	732	741	746	823
	2 400	739	745	754	760	840
	2 500	749	755	764	770	854
	2 600	763	769	778	784	871
	2 700				796	887
	2 800				808	902
	2 900				820	918
	3 000				836	937
	3 100				848	952
	3 200				860	968
	3 300				872	983

OVERLAPPING FRAME

	INSTALLATION OPENING, HEIGHT, MM	INSTALLATION OPENING, WIDTH, MM				
		1 500	1 600	1 700	1 800	1 900
RAL 9003	1 800	759	763	767	772	776
	1 900	772	776	781	785	790
	2 000	785	789	794	799	804
	2 100	802	806	811	816	821
	2 200	815	820	825	830	835
	2 300	828	833	839	844	849
	2 400	845	851	856	861	867
	2 500	860	865	871	876	881
	2 600	877	883	888	894	899
	2 700	892	898	904	910	915
	2 800	908	914	920	926	931
	2 900	924	930	936	942	948
	3 000	943	949	955	962	968
	3 100	958	965	971	978	984
	3 200	975	981	988	994	1 000
	3 300	990	997	1 003	1 010	1 017

OVERLAPPING FRAME

	INSTALLATION OPENING, HEIGHT, MM	INSTALLATION OPENING, WIDTH, MM						
		2 000	2 100	2 200	2 300	2 400	2 500	2 600
RAL 9003	1 800	781	785	790	794	798	803	807
	1 900	795	799	804	808	813	818	822
	2 000	809	813	818	823	827	832	837
	2 100	826	831	836	841	846	851	856
	2 200	840	845	850	855	860	865	870
	2 300	854	860	865	870	875	880	886
	2 400	872	878	883	888	894	899	905
	2 500	887	892	898	903	909	914	920
	2 600	905	911	916	922	927	933	939
	2 700	921	927	933	938	944	950	956
	2 800	938	943	949	955	961	967	973
	2 900	954	960	966	972	978	984	990
	3 000	974	981	987	993	999	1 006	1 012
	3 100	991	997	1 003	1 010	1 016	1 023	1 029
	3 200	1 007	1 014	1 020	1 027	1 033	1 040	1 046
	3 300	1 024	1 030	1 037	1 044	1 050	1 057	1 064

OUR DOORS ARE AVAILABLE IN CUSTOM SIZES TO INSURE BEST COMMERCIAL APPLICATION

DOOR CATALOGUE CODES

TSD	SWINGING SINGLE LEAF DOORS
TDD	SWINGING DOUBLE LEAF DOORS
RIGHT / LEFT	HINGES ON THE RIGHT / HINGES ON THE LEFT

EXAMPLE OF DOOR CATALOGUE CODE: TSD 800 2000 40 RAL9003/RAL9003 ANG RIGHT

DOOR TYPE	DOORWAY WIDTH	DOORWAY HEIGHT	DOOR THICKNESS	COVERING MATERIAL		FRAME TYPE	HINGES LOCATION
				EXTERIOR METAL	INTERIOR METAL		
TSD	800	2 000	40	RAL9003	RAL9003	ANGULAR	RIGHT

ADDITIONAL OPTIONS FOR TRAFFIC SWINGING DOORS

ITEM	PRICE
TDD FRAME INSTALLATION HARDWARE TO INSULATED SANDWICH PANELS	12
PANELS	8
TDD FRAME INSTALLATION HARDWARE TO A BRICK WALL	7
TSD FRAME INSTALLATION HARDWARE TO A BRICK WALL	4
FRAME INSTALLATION HARDWARE FOR STEEL STUD CONSTRUCTION	2
DOOR BLADE MATERIAL: AISI 304, PRICE FOR 1 SQ. M	30
DOOR BLADE MATERIAL: AISI 430, PRICE FOR 1 SQ. M	21
OVERHEAD FRAME AISI 304, PRICE FOR RUNNING METER	20
ANGULAR FRAME AISI 304, PRICE FOR RUNNING METER	32
OVERLAPPING FRAME AISI 304, PRICE FOR RUNNING METER	75
OVERHEAD FRAME AISI 430, PRICE FOR RUNNING METER	11
ANGULAR FRAME AISI 430, PRICE FOR RUNNING METER	18
OVERLAPPING FRAME AISI 430, PRICE FOR RUNNING METER	43
HIDDEN INSTALLATION HARDWARE FOR TSD	41
HIDDEN INSTALLATION HARDWARE FOR TDD	48
HIDDEN INSTALLATION HARDWARE FOR TSD WITH AISI 304 FRAME	56
HIDDEN INSTALLATION HARDWARE FOR TDD WITH AISI 304 FRAME	66
HIDDEN INSTALLATION HARDWARE FOR TSD WITH AISI 430 FRAME	50
HIDDEN INSTALLATION HARDWARE FOR TDD WITH AISI 304 FRAME	59

FACTORY INSTALLED BUMPERS FOR TSD

BUMPER MATERIAL	THICKNESS, MM	PRICE FOR SQ. M	PRICE FOR RUNNING METER	
			BOTTOM 0,25 M	BOTTOM 0,5 M
AISI 304	1,5	100	25	50
AISI 430	1,5	67	17	33
ALUMINIUM CHECKER PLATE	1,5	53	13	26
FLAT HDP PLASTIC	4,0	30	7	15
CURVED HDP PLASTIC	6,0	43	11	22

FACTORY INSTALLED BUMPERS FOR TDD

BUMPER MATERIAL	THICKNESS, MM	PRICE FOR SQ. M	PRICE FOR RUNNING METER	
			BOTTOM 0,25 M	BOTTOM 0,5 M
AISI 304	1,5	105	26	53
AISI 430	1,5	69	17	35
ALUMINIUM CHECKER PLATE	1,5	56	14	28
FLAT HDP PLASTIC	4,0	31	8	15
CURVED HDP PLASTIC	4,0	35	9	18
CURVED HDP PLASTIC	6,0	44	11	22

PACKAGING

ITEM	PRICE
STRETCH-WRAP	INCLUDED IN DOOR PRICE
CARDBOARD PACKAGING	CALCULATED INDIVIDUALLY FOR YOUR ORDER
WOODEN PACKAGING	CALCULATED INDIVIDUALLY FOR YOUR ORDER



PROFHOLOD

+7 (495) 745-01-37

WWW.PROFHOLOD.COM