

TRAFFIC SWINGING SINGLE LEAF DOORS

ALL PRICES IN US DOLLARS, DO NOT INCLUDE VAT. 2 MM THICK METAL DOOR FRAME INCLUDED

(TSD)

08.07.2024

- traffic of personnel.
- The factory-made doors are ready for installation on technological, industrial premises, supermarkets, hospitals, food production facilities, cafes, restaurants, etc.
- Traffic doors are not meant to completely seal the opening due to technical clearance gaps along the perimeter between the frame and the door leaf.
- If you need the doors to remain open in 90-degree position, you can order traffic doors with fixing hinges. Doors can be equipped with oval windows of 200x500 or 300x580 mm.
- Traffic doors are available in custom sizes and are equipped with the European-made hardware: Italian, Spanish, — according to customer's request.

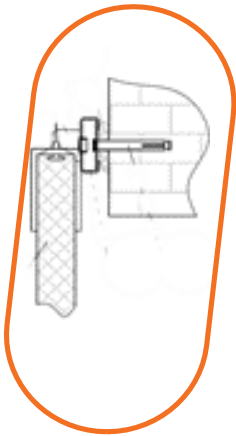

OVERHEAD FRAME

RAL 9003	INSTALLATION OPENING, HEIGHT, MM	INSTALLATION OPENING, WIDTH, MM						
		700	800	900	1 000	1 100	1 200	1 300
1 800	358	394	402	413	421	437	519	
1 900	362	401	408	420	428	513	526	
2 000	366	407	414	427	435	520	534	
2 100	371	413	421	433	508	527	542	
2 200	377	421	429	442	517	537	551	
2 300	384	431	439	519	528	549	634	
2 400	389	437	445	526	535	556	642	
2 500	472	524	534	550	560	582	671	
2 600	477	531	541	557	568	662	680	
2 700	483	539	549	566	576	670	689	
2 800	489	547	558	575	655	680	699	
2 900	561	622	633	652	664	689	708	
3 000	566	629	641	660	672	698	717	
3 100	573	638	650	669	681	708	727	
3 200	578	645	657	677	690	716	737	
3 300	584	653	666	685	698	726	746	

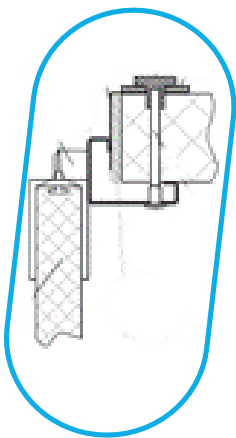

ANGULAR FRAME

RAL 9003	INSTALLATION OPENING, HEIGHT, MM	INSTALLATION OPENING, WIDTH, MM						
		700	800	900	1 000	1 100	1 200	1 300
1 800	379	417	425	437	445	463	546	
1 900	384	424	432	444	453	540	555	
2 000	389	430	439	452	460	548	563	
2 100	394	437	446	459	535	556	571	
2 200	399	444	453	466	543	564	579	
2 300	408	456	465	546	557	578	666	
2 400	413	463	472	554	565	587	675	
2 500	497	551	562	578	589	612	703	
2 600	504	560	571	588	599	695	714	
2 700	513	571	582	599	611	708	727	
2 800	519	579	591	608	691	718	737	
2 900	593	655	668	687	700	727	747	
3 000	600	665	678	698	711	738	759	
3 100	607	673	686	707	720	748	769	
3 200	612	680	694	714	728	756	778	
3 300	621	692	705	726	740	769	791	





OVERLAPPING FRAME

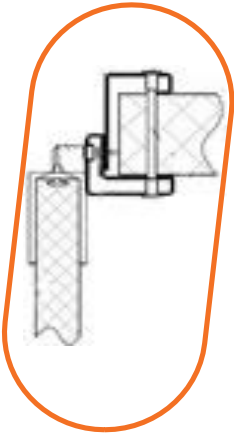

RAL 9003

INSTALLATION OPENING, HEIGHT, MM	INSTALLATION OPENING, WIDTH, MM						
	700	800	900	1 000	1 100	1 200	1 300
1 800	449	490	501	516	526	547	637
1 900	457	500	510	526	537	630	648
2 000	469	514	524	541	552	647	665
2 100	476	523	534	551	633	658	677
2 200	484	533	544	561	643	669	688
2 300	496	548	559	647	660	686	781
2 400	504	558	570	659	672	698	793
2 500	598	657	670	690	704	732	831
2 600	608	669	682	703	717	823	846
2 700	617	680	694	715	730	835	859
2 800	627	692	706	728	817	849	873
2 900	707	775	790	814	829	862	887
3 000	719	789	805	829	845	878	903
3 100	728	801	816	841	857	891	917
3 200	734	808	824	849	866	900	926
3 300	744	820	837	862	879	914	940

OUR DOORS ARE AVAILABLE IN CUSTOM SIZES TO INSURE BEST COMMERCIAL APPLICATION

TRAFFIC SWINGING DOUBLE LEAF DOORS

ALL PRICES IN US DOLLARS, DO NOT INCLUDE VAT. 2 MM THICK METAL DOOR FRAME INCLUDED

(TDD)

08.07.2024

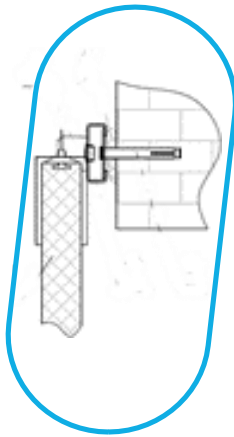

RAL 9003

OVERHEAD FRAME

INSTALLATION OPENING, HEIGHT, MM	INSTALLATION OPENING, WIDTH, MM				
	1 000	1 100	1 200	1 300	1 400
1 800	662	666	674	677	744
1 900	670	674	682	685	756
2 000	678	682	690	694	769
2 100	686	690	698	702	780
2 200	694	698	707	711	793
2 300	709	713	722	726	813
2 400	724	729	738	743	834
2 500	885	889	899	904	1 000
2 600	900	905	914	919	1 019
2 700				931	1 034
2 800				943	1 051
2 900				1 097	1 208
3 000				1 108	1 224
3 100				1 120	1 239
3 200				1 131	1 254
3 300				1 144	1 271

OVERHEAD FRAME

INSTALLATION OPENING, HEIGHT, MM	INSTALLATION OPENING, WIDTH, MM				
	1 500	1 600	1 700	1 800	1 900
1 800	748	751	755	758	762
1 900	760	763	767	771	774

RAL 9003	2 000	772	776	780	784	788
	2 100	784	788	792	796	800
	2 200	797	801	805	809	814
	2 300	817	821	826	830	973
	2 400	838	843	847	852	996
	2 500	1 005	1 010	1 014	1 019	1 024
	2 600	1 024	1 029	1 034	1 039	1 044
	2 700	1 040	1 045	1 050	1 055	1 060
	2 800	1 057	1 062	1 067	1 073	1 078
	2 900	1 214	1 219	1 225	1 230	1 236
	3 000	1 229	1 235	1 241	1 246	1 252
	3 100	1 245	1 251	1 257	1 263	1 268
	3 200	1 260	1 266	1 272	1 278	1 284
	3 300	1 277	1 283	1 289	1 296	1 302

OVERHEAD FRAME

	INSTALLATION OPENING, HEIGHT, MM	INSTALLATION OPENING, WIDTH, MM						
		2 000	2 100	2 200	2 300	2 400	2 500	2 600
RAL 9003	1 800	765	792	795	799	802	947	952
	1 900	778	805	809	954	957	961	966
	2 000	791	819	823	968	972	976	981
	2 100	804	973	978	982	986	990	995
	2 200	818	988	992	996	1 001	1 005	1 010
	2 300	977	1 011	1 016	1 020	1 025	1 172	1 177
	2 400	1 001	1 036	1 041	1 045	1 050	1 199	1 205
	2 500	1 029	1 065	1 069	1 074	1 079	1 231	1 237
	2 600	1 049	1 086	1 091	1 242	1 247	1 252	1 259
	2 700	1 065	1 103	1 108	1 259	1 265	1 270	1 277
	2 800	1 083	1 268	1 273	1 279	1 284	1 290	1 296
	2 900	1 241	1 284	1 290	1 296	1 301	1 307	1 314
	3 000	1 258	1 301	1 307	1 313	1 319	1 324	1 332
	3 100	1 274	1 319	1 325	1 331	1 337	1 343	1 350
	3 200	1 290	1 335	1 342	1 348	1 354	1 360	1 368
	3 300	1 308	1 354	1 360	1 366	1 373	1 379	1 387

ANGULAR FRAME

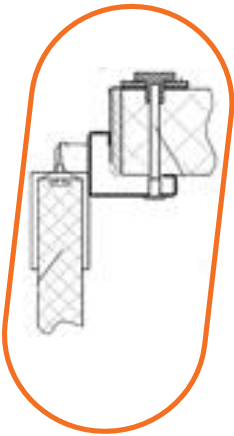

	INSTALLATION OPENING, HEIGHT, MM	INSTALLATION OPENING, WIDTH, MM				
		1 000	1 100	1 200	1 300	1 400
RAL 9003	1 800	685	689	697	701	769
	1 900	694	698	707	711	782
	2 000	703	707	716	720	796
	2 100	712	716	725	730	809
	2 200	721	725	735	739	822
	2 300	737	741	751	755	843
	2 400	753	758	768	772	865
	2 500	915	920	930	935	1 032
	2 600	930	935	945	950	1 052
	2 700				963	1 067
	2 800				975	1 083
	2 900				1 129	1 242
	3 000				1 143	1 259
	3 100				1 155	1 275
	3 200				1 165	1 290
	3 300				1 177	1 305

ANGULAR FRAME

	INSTALLATION OPENING, HEIGHT, MM	INSTALLATION OPENING, WIDTH, MM			
		1 500	1 600	1 700	1 800
1 800	773	777	781	784	788
1 900	786	790	794	798	802
2 000	800	804	808	812	816
2 100	813	818	822	826	831
2 200	827	831	836	840	845

RAL 9003	2 300	848	853	857	862	1 007
	2 400	870	875	880	885	1 031
	2 500	1 037	1 042	1 047	1 053	1 058
	2 600	1 057	1 062	1 068	1 073	1 078
	2 700	1 073	1 078	1 084	1 089	1 095
	2 800	1 089	1 095	1 100	1 106	1 112
	2 900	1 248	1 254	1 260	1 265	1 271
	3 000	1 265	1 271	1 277	1 283	1 289
	3 100	1 281	1 287	1 294	1 300	1 306
	3 200	1 296	1 302	1 309	1 315	1 322
	3 300	1 312	1 318	1 325	1 331	1 338

ANGULAR FRAME

	INSTALLATION OPENING, HEIGHT, MM	INSTALLATION OPENING, WIDTH, MM						
		2 000	2 100	2 200	2 300	2 400	2 500	2 600
RAL 9003	1 800	792	820	824	828	832	978	984
	1 900	806	835	839	985	989	993	1 000
	2 000	821	850	854	1 001	1 005	1 009	1 016
	2 100	835	1 007	1 012	1 016	1 021	1 025	1 032
	2 200	849	1 022	1 027	1 031	1 036	1 041	1 048
	2 300	1 011	1 047	1 052	1 056	1 061	1 210	1 217
	2 400	1 036	1 072	1 078	1 083	1 088	1 239	1 246
	2 500	1 063	1 100	1 105	1 111	1 116	1 268	1 276
	2 600	1 084	1 122	1 127	1 280	1 285	1 291	1 299
	2 700	1 100	1 139	1 145	1 298	1 304	1 309	1 317
	2 800	1 117	1 304	1 310	1 316	1 322	1 327	1 336
	2 900	1 277	1 322	1 328	1 334	1 340	1 346	1 354
	3 000	1 295	1 341	1 347	1 353	1 359	1 365	1 374
	3 100	1 312	1 358	1 364	1 371	1 377	1 384	1 392
3 200	1 328	1 374	1 381	1 387	1 394	1 401	1 409	
3 300	1 345	1 392	1 398	1 405	1 412	1 419	1 428	

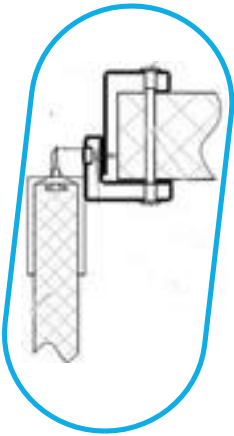

OVERLAPPING FRAME

	INSTALLATION OPENING, HEIGHT, MM	INSTALLATION OPENING, WIDTH, MM				
		1 000	1 100	1 200	1 300	1 400
RAL 9003	1 800	769	774	784	789	861
	1 900	782	788	798	803	879
	2 000	794	799	809	815	894
	2 100	808	813	824	830	913
	2 200	819	825	835	841	929
	2 300	839	845	856	863	955
	2 400	862	868	879	886	983
	2 500	1 031	1 038	1 049	1 056	1 157
	2 600	1 048	1 055	1 066	1 073	1 178
	2 700				1 088	1 197
	2 800				1 104	1 217
	2 900				1 266	1 382
	3 000				1 284	1 405
	3 100				1 300	1 424
3 200				1 311	1 440	
3 300				1 326	1 459	

OVERLAPPING FRAME

	INSTALLATION OPENING, HEIGHT, MM	INSTALLATION OPENING, WIDTH, MM				
		1 500	1 600	1 700	1 800	1 900
9003	1 800	866	871	877	882	887
	1 900	884	890	895	900	906
	2 000	900	905	911	917	922
	2 100	919	925	930	936	942
	2 200	935	941	946	952	958
	2 300	961	967	973	979	1 130
	2 400	989	996	1 002	1 009	1 161
	2 500	1 163	1 170	1 177	1 183	1 190

RAL	2 600	1 185	1 192	1 199	1 205	1 212
	2 700	1 204	1 211	1 218	1 225	1 232
	2 800	1 224	1 231	1 238	1 245	1 252
	2 900	1 390	1 397	1 404	1 412	1 419
	3 000	1 413	1 420	1 428	1 435	1 443
	3 100	1 432	1 440	1 447	1 455	1 463
	3 200	1 448	1 456	1 464	1 471	1 479
	3 300	1 467	1 475	1 483	1 491	1 499

OVERLAPPING FRAME

INSTALLATION OPENING, HEIGHT, MM	INSTALLATION OPENING, WIDTH, MM							
	2 000	2 100	2 200	2 300	2 400	2 500	2 600	
RAL 9003	1 800	893	925	930	936	941	1 093	1 104
	1 900	911	944	950	1 102	1 108	1 114	1 125
	2 000	928	962	967	1 120	1 126	1 132	1 143
	2 100	948	1 130	1 135	1 141	1 147	1 154	1 165
	2 200	965	1 147	1 153	1 159	1 165	1 172	1 184
	2 300	1 136	1 177	1 183	1 190	1 196	1 351	1 364
	2 400	1 168	1 210	1 217	1 223	1 230	1 387	1 400
	2 500	1 197	1 240	1 246	1 253	1 260	1 418	1 431
	2 600	1 219	1 263	1 270	1 428	1 435	1 442	1 455
	2 700	1 240	1 284	1 291	1 449	1 456	1 464	1 477
	2 800	1 260	1 456	1 463	1 470	1 478	1 485	1 499
	2 900	1 427	1 477	1 484	1 492	1 500	1 507	1 521
	3 000	1 450	1 502	1 509	1 517	1 525	1 533	1 547
	3 100	1 471	1 523	1 531	1 539	1 547	1 555	1 569
	3 200	1 487	1 540	1 548	1 556	1 564	1 573	1 587
	3 300	1 508	1 561	1 569	1 578	1 586	1 594	1 609

OUR DOORS ARE AVAILABLE IN CUSTOM SIZES TO INSURE BEST COMMERCIAL APPLICATION

DOOR CATALOGUE CODES

TSD	SWINGING SINGLE LEAF DOORS
TDD	SWINGING DOUBLE LEAF DOORS
RIGHT / LEFT	HINGES ON THE RIGHT / HINGES ON THE LEFT

EXAMPLE OF DOOR CATALOGUE CODE: TSD 800 2000 40 RAL9003/RAL9003 ANG RIGHT

DOOR TYPE	DOORWAY WIDTH	DOORWAY HEIGHT	DOOR THICKNESS	COVERING MATERIAL		FRAME TYPE	HINGES LOCATION
				EXTERIOR METAL	INTERIOR METAL		
TSD	800	2 000	40	RAL9003	RAL9003	ANGULAR	RIGHT

ADDITIONAL OPTIONS FOR TRAFFIC SWINGING DOORS

ITEM	PRICE
TDD FRAME INSTALLATION HARDWARE TO INSULATED SANDWICH PANELS	13
PANELS	9
TDD FRAME INSTALLATION HARDWARE TO A BRICK WALL	8
TSD FRAME INSTALLATION HARDWARE TO A BRICK WALL	4
FRAME INSTALLATION HARDWARE FOR STEEL STUD CONSTRUCTION	2
DOOR BLADE MATERIAL: AISI 304, PRICE FOR 1 SQ. M	33
DOOR BLADE MATERIAL: AISI 430, PRICE FOR 1 SQ. M	23
OVERHEAD FRAME AISI 304, PRICE FOR RUNNING METER	19
ANGULAR FRAME AISI 304, PRICE FOR RUNNING METER	33
OVERLAPPING FRAME AISI 304, PRICE FOR RUNNING METER	86
OVERHEAD FRAME AISI 430, PRICE FOR RUNNING METER	11
ANGULAR FRAME AISI 430, PRICE FOR RUNNING METER	19

OVERLAPPING FRAME AISI 430, PRICE FOR RUNNING METER	50
HIDDEN INSTALLATION HARDWARE FOR TSD	46
HIDDEN INSTALLATION HARDWARE FOR TDD	54
HIDDEN INSTALLATION HARDWARE FOR TSD WITH AISI 304 FRAME	63
HIDDEN INSTALLATION HARDWARE FOR TDD WITH AISI 304 FRAME	57
HIDDEN INSTALLATION HARDWARE FOR TSD WITH AISI 430 FRAME	75
HIDDEN INSTALLATION HARDWARE FOR TDD WITH AISI 304 FRAME	66

FACTORY INSTALLED BUMPERS FOR TSD

BUMPER MATERIAL	THICKNESS, MM	PRICE FOR SQ. M	PRICE FOR RUNNING METER	
			BOTTOM 0,25 M	BOTTOM 0,5 M
AISI 304	1,5	113	28	57
AISI 430	1,5	75	19	38
ALUMINIUM CHECKER PLATE	1,5	52	13	26
FLAT HDP PLASTIC	4,0	34	8	17
CURVED HDP PLASTIC	6,0	47	12	24

FACTORY INSTALLED BUMPERS FOR TDD

BUMPER MATERIAL	THICKNESS, MM	PRICE FOR SQ. M	PRICE FOR RUNNING METER	
			BOTTOM 0,25 M	BOTTOM 0,5 M
AISI 304	1,5	119	30	59
AISI 430	1,5	78	19	39
ALUMINIUM CHECKER PLATE	1,5	54	14	27
FLAT HDP PLASTIC	4,0	35	9	17
CURVED HDP PLASTIC	4,0	40	10	20
CURVED HDP PLASTIC	6,0	48	12	24

PACKAGING

ITEM	PRICE
STRETCH-WRAP	INCLUDED IN DOOR PRICE
CARDBOARD PACKAGING	CALCULATED INDIVIDUALLY FOR YOUR ORDER
WOODEN PACKAGING	CALCULATED INDIVIDUALLY FOR YOUR ORDER



+7 (495) 745-01-37

WWW.PROFHOLOD.COM